

Back to back handles are supplied with befeater bolts for a secure fixing. Standard bolts are designed for 45mm - 55mm width doors. For thicker doors of 60mm and over, please advise thickness when ordering. Please also state when ordering for glass doors.

As an alternative to back to back handles, roses or plates can be bolted through for extra security using 'T' fix bolts.

Please refer to our price list for standard sizes for pull handles on plates. Specials can be produced to any size and gauge.

Bolt through

- 16RBT150
- 16RBT225
- 16RBT300
- 20RBT150
- 20RBT225
- 20RBT300
- 22RBT150
- 22RBT225
- 22RBT300
- 26RBT150
- 26RBT225
- 26RBT300

On concealed rose

- 16RCR150
- 16RCR225
- 16RCR300
- 20RCR150
- 20RCR225
- 20RCR300
- 22RCR150
- 22RCR225
- 22RCR300
- 26RCR150
- 26RCR225
- 26RCR300

Cranked bolt through

- 20RBTCR150
- 20RBTCR225
- 20RBTCR300
- 20RBTCR425
- 20RBTCR600
- 22RBTCR150
- 22RBTCR225
- 22RBTCR300
- 22RBTCR425
- 22RBTCR600
- 25RBTCR150
- 25RBTCR225
- 25RBTCR300
- 25RBTCR425
- 25RBTCR600

Back to back

- 16RBB150
- 16RBB225
- 16RBB300
- 20RBB150
- 20RBB225
- 20RBB300
- 22RBB150
- 22RBB225
- 22RBB300
- 26RBB150
- 26RBB225
- 26RBB300

Cranked back to back

- 20RBBCR225
- 20RBBCR300
- 20RBBCR425
- 22RBBCR225
- 22RBBCR300
- 22RBBCR425
- 22RBBCR600
- 25RBBCR225
- 25RBBCR300
- 25RBBCR425
- 25RBBCR600

On plate

- 16RPP150
- 16RPP225
- 16RPP300
- 20RPP150
- 20RPP225
- 20RPP300
- 22RPP150
- 22RPP225
- 22RPP300
- 26RPP150
- 26RPP225
- 26RPP300

On engraved plate

- 16REP150
- 16REP225
- 16REP300
- 20REP150
- 20REP225
- 20REP300
- 22REP150
- 22REP225
- 22REP300
- 26REP150
- 26REP225
- 26REP300

On square plate

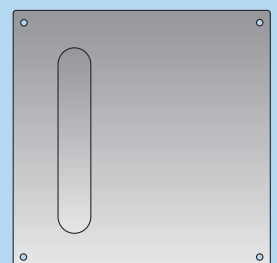

170 x 170mm

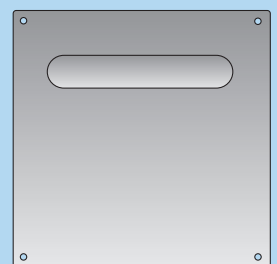

Witley suite - pull handles

A range offering four diameters and four lengths as standard with the option of specifying any length required.

All the items listed are available in the following finishes; AS, PB, SSS, PSS

Refer to page 3 for glossary of finishes.

Please contact our sales office for alternative finishes.